

Test date: 20th May 2013

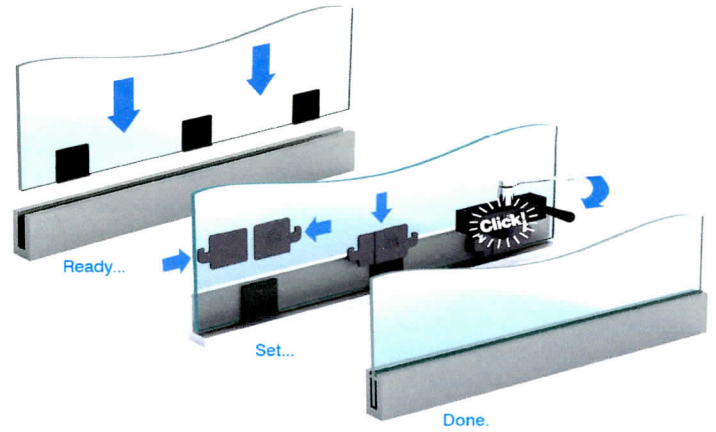

## Freestanding glass barrier Tested To BS6180:2011

Ref: CRLTL0024

### Components

Clamping rail: C.R.L TAPERLOC® B5G10F (fascia mounted aluminium base shoe profile).  
 TAPERLOC® wedges Spaced at 300 mm centres  
 Handrail: Continuous (as described in BS 6180:2011)  
 Top rail continuously seated, or through glass fixed rail with minimum two connector brackets per pane not more than 1000 mm apart.

**Intended load resistance:** 0.36 kN/m line load, 0.25 kN/m concentrated load, 0.5 kN/m<sup>2</sup> uniform load.

### Test sample

Pane size 1100 mm wide x 1195 mm high.  
 Clamping rail position Top edge of profile installed at finished floor level.  
 Load application 1100 mm above finished floor level.

### Test results

Load	Results
0.36 kN/m line load applied across whole width of pane	Deflection 20.1 mm
0.25 kN concentrated load applied at centre of width of pane	Deflection 12.6 mm
0.54 kN/m line load applied across whole width of pane	No failure, no permanent distortion
0.38 kN concentrated load applied at centre of width of pane	No failure, no permanent distortion

### Range of applicability

Suitable for any pane width greater than 450 mm, provided there is a continuous handrail.  
 Suitable for pane heights up to 1500 mm above finished floor level, subject to a wind load resistance check if used externally.

### Usage constraints

Not appropriate if mounted with the top edge of the clamping rail more than 10 mm below finished floor level.  
 TL5X10 TAPERLOC® wedges installed at 300 mm are required to meet the BS6180:2011 loadings.

Signed



Simon J Boocock  
 Managing Director  
 C.R. Laurence of Europe Ltd, Charles Babbage Avenue, Kingsway Business Park, Rochdale, OL16 4NW

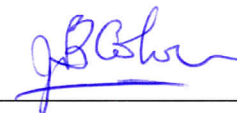

Witnessed by:  
 John Bernard Colvin M.A. (Cantab.)  
 Glass Consultant  
 JCGC Limited, 227 Ormskirk Road, Upholland, Skelmersdale, WN8 9AH